

REV.	ECN NO.	DESCRIPTION	DESIGN	DATE
A		INITIAL	Kai	2018.03.29

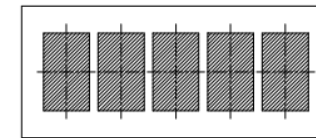
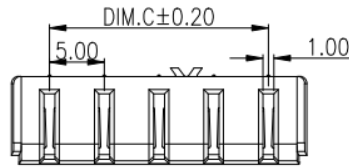
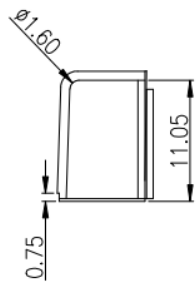
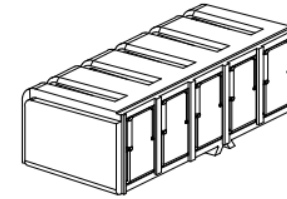
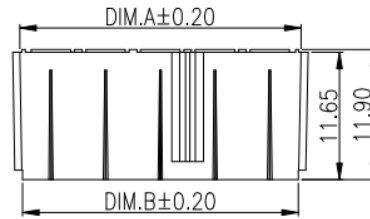
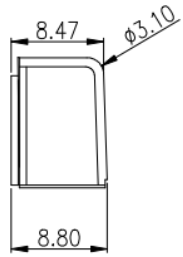

RECOMMENDED P.C.BOARD LAYOUT

NOTE:

Material

Insulator:Nylon 9T(UL94V-0)

Contact:phosphor Bronze

Contact Plated:Gold over Nickel or Tin Specification

Rated voltage: 12V 30V

Current rating: 3A 5A

instant CURRENT:7A

Contact Resistance:30MΩ

Insulation Resistance:100MΩ

Dielectric Voltage:1000V

Operdting Temperature:-40°~105°

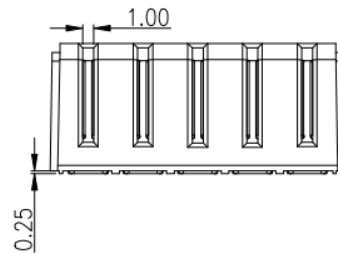
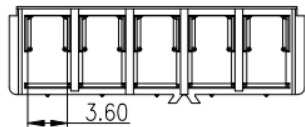

UNLESS OTHERWISE SPECIFED TOLERANCES

东莞市高迪电子有限公司

ITEM	PART NAME	Q'TY	MATERIAL	DESCRIPTION	REMARK
②	HOUSING	1	LCP		BLACK
①	CONTACT A	2	PHOSPHOR BRONZE 0.20T	Au PLATED	

DECIMALS:		ANGLES:	
DIM	TOL	DIM	TOL
X.	±0.50	X.	±2°
X.X	±0.30	X.X	±1°
X.XX	±0.20	X.XX	
X.XXX	±0.10	X.XXX	

DWG NO.	
DESIGN:	
CHECK:	
APPROVED	

PART NAME:			
PART NO.			
REV. A	UNIT: mm	SHEET: 1/1	⊕